

# RUNNING MAN, DIRECTIONAL ARROWS | EXIT SIGNS

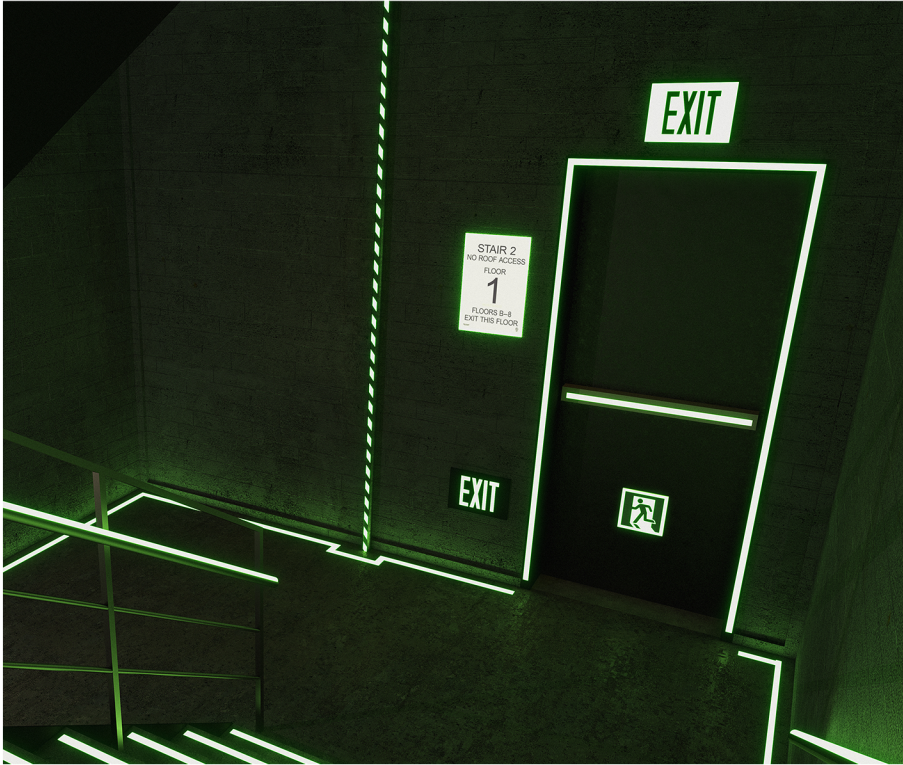

**Photoluminescent Directional Exit Signs** visually identify the path to the final exit door. Exit signs should be placed in a continuous and unbroken manner along the escape routes of an egress stairway.

The Running Man Left (**DRML**) or Right (**DRMR**) Sign must be centered on the exit door, no higher than 18" from the floor, to inform the occupant of the exit path through the exit doorway. **Every door in the exit path must be marked.**

Combine one Running Man with one Arrow Sign (**DAD** or **DAS**) to create proper directional exit signage. Mark each floor landing with only four symbols, to show any direction of your egress path.

- Required in New York, NY
- Required for final egress exit door
- 5" x 5" photoluminescent background

**Code Compliant in all 50 states and Canada:**

Exceeds ASTM E2072 glow requirements

Code compliant: ICC/IBC/IFC/ASTM E2072/NFPA 101/OSHA/ADA

UL 1994 listed



5-Year Warranty

## Safe-T-Nose®

LEAVE NO DOUBT • THIS WAY OUT • EXIT SAFELY

